

NEWS PRINT

What's new in the world of garden design *Compiled by Zia Allaway*

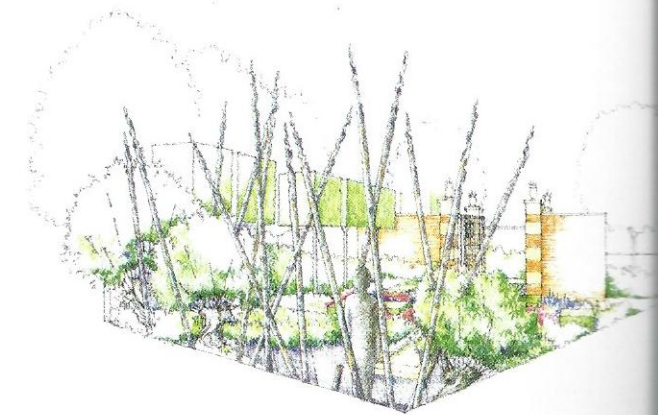

SGD MEMBERS BATTLE FOR TOP PRIZES AT CHELSEA 2015

MEMBERS AND pre-registered members of the SGD will be presenting four out of the 15 main Show Gardens at this year's RHS Chelsea Flower Show.

Jo Thompson is returning to Chelsea for the sixth time in seven years and will be presenting a garden for show sponsor, M&G Investments. She will create a quintessentially British garden, with a tree-lined retreat that includes a two-storey oak-framed building, natural swimming pond, and tumbling roses and peonies. "It is an honour to have been asked by M&G to design this garden," said Jo. "No matter how many times I do this, it's always nerve-wracking yet terribly exciting."

It is over a decade since Dan Pearson MSGD created his last Chelsea garden

for Merrill Lynch, and this year he will be returning with a Chatsworth-inspired design for Laurent-Perrier. Showcasing Dan's planting prowess, the garden takes inspiration from elements of the ornamental trout stream and Paxton's rockery at the Chatsworth estate in Derbyshire, and will include a mix of damp woodland and woodland edge plants, as well as aquatics.

Following their Gold and Best of Show awards at the Singapore Garden Festival, Andrew Wilson and Gavin McWilliam are hoping to match their success with a Chelsea garden to mark the bicentenary of Wellington's victory at the Battle of Waterloo. Inspired by the landscape of Waterloo, the battle formations and regimental colours of the

allied troops, the garden will also include personal carvings made by pupils of Wellington College.

Having scooped Best Fresh Garden in 2013, James Basson is this year creating his first main Show Garden. 'A Perfumer's Garden in Grasse', sponsored by L'Occitane UK Ltd, is based on the historical garden of a perfume grower in Grasse, Provence, and James' design will transport visitors to the Mediterranean with scented plants, including *Osmanthus*, irises, bergamot, lavender and thyme. James said: "Living and working in Grasse, I have a good knowledge of the area and plants, and it is at the heart of our work outside the show garden world."

www.rhs.org.uk

TOP (CLOCKWISE FROM TOP RIGHT) Designs by Andrew Wilson and Gavin McWilliam, James Basson and Dan Pearson

LEFT Design by Jo Thompson



Waterloo goes green

LOCAL RESIDENTS and businesses, 'eco-warriors' from Johanna Primary School and volunteers from Oasis Academy South Bank have implemented a new planting project in the Waterloo area in south London. Commissioned by Waterloo Quarter Business Improvement District (BID) and supported by the Mayor of London, the scheme will provide green infrastructure in the Waterloo and South Bank area, aiming to increase biodiversity and address the impacts of climate change. The scheme is in response to opportunities identified by a 2012 green infrastructure audit, and the designs have been created by local landscape consultants, (uncommon), run by Deborah Nagan, who have used 60 recycled barrels to create planters that can be arranged in a number of configurations.

The planters will be watered from down-pipes from neighbouring buildings, and the plants chosen are attractive 'urban weeds', including buddleia, daisies, honeysuckle and ivy, which can endure the city heat and pollution. Five initial sites have been selected for the first stage of the scheme but the intention is for the planters to eventually populate the whole area. "Our ambition is to make this part of London greener and more bio-diverse – creating a more environmentally sustainable and pleasant place to live and work," said Helen Santer, CEO of Waterloo Quarter. www.waterlooquarter.org

